

CMI-DIO06

CMI Module with 16x Optical Isolated DIO (8 in / 8 out)

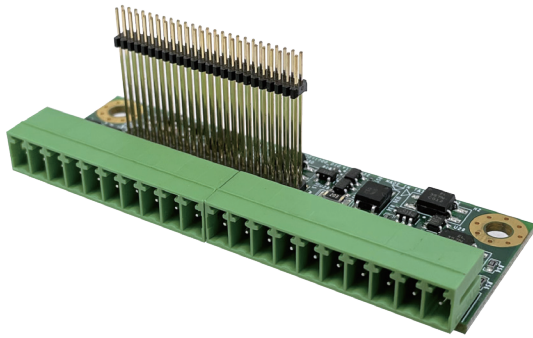

- CMI (Combined Multiple I/O) Technology
- Optical Isolated Design
- Wide Range DC Power Input

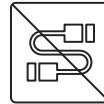
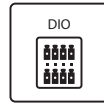

Specifications

Interface	CMI (Combined Multiple I/O) Interface
Digital I/O Port	16x Optical Isolated DIO (8DI, 8DO)
Connector Type	2x 10-pin Terminal Block, 3.5mm pitch
Optical Isolated DIO	3.75kV
Isolated Power Input	9 ~ 30VDC
Input Driving Sink Current	Minimal: 1 mA Normal: 5 mA
Dimension (W x D x H)	74 x 27.3 x 25 mm

Dimensions

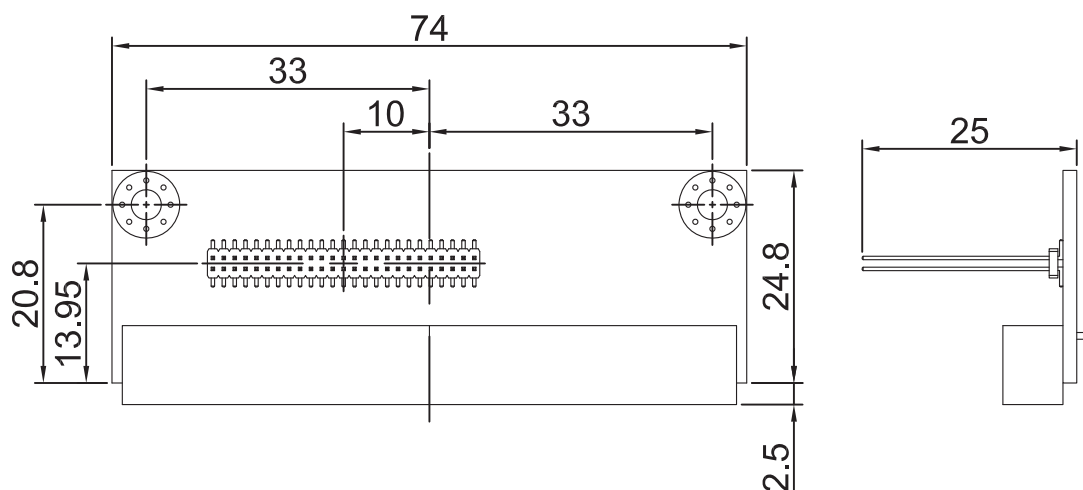

Unit: mm

Ordering Information

Available Models

CMI-DIO06-R10	CMI Module with 16DIO (8in 8out)
----------------------	----------------------------------

Package Check List

- CMI Module x1
- Terminal Block Pack x1
- Screw Pack x1

Compatible List

Model No.	CMI-DIO06
DV-1000	V